

Material:  
 Tungsten Carbide

| SHANK TABLE |   |   |
|-------------|---|---|
| SHANK       | SHANK DIAMETER (SD)<br>in./mm<br>+.0001/.003<br>-.0002/.005 | SHANK DIAMETER<br>FLAT (SDF)<br>in./mm<br>±.0005/.013 |
| 1/16A       | 0.0624/1.585  | 0.0590/1.500  |
| 2mm         | 0.0786/2.000  | 0.0630/1.600  |
| 3/32        | 0.0936/2.377  | 0.0880/2.235  |
| 3mm         | 0.1179/2.995  | 0.0900/2.290  |
| 1/8         | 0.1249/3.172  | 0.1180/3.000  |

Specify: Series/Wire Feed Angle - Wire Diameter - Shank(See Table) - Length

Example:  
 2830-5-1/16A-L  
 2830-12-1/8-1.0

| 2830 SERIES<br>PART<br>NUMBER | H<br>in./μm<br>±.0005/13 | BL<br>in./μm<br>±.0005/13 | W<br>in./μm<br>±.0005/13 | C<br>in./μm<br>±.0005/13 | FR<br>in./μm<br>±.0005/13 | BR<br>in./μm<br>±.0005/13 | T<br>in./mm<br>±.001/.025 | MINIMUM<br>SHANK<br>DIAMETER | CD<br>in./μm<br>±.0005/13 | SUGGESTED<br>WIRE<br>DIAMETER<br>in./μm |
|-------------------------------|--------------------------|---------------------------|--------------------------|--------------------------|---------------------------|---------------------------|---------------------------|------------------------------|---------------------------|---|
| <b>2830-3</b>                 | .0045/114                | .0070/178                 | .0100/254                | .0050/127                | .0060/152                 | .0040/102                 | .059/1.50                 | 1/16A                        | .0008/20                  | .003/76                                 |
| <b>2830-4</b>                 | .0060/152                | .0100/254                 | .0120/305                | .0070/178                | .0080/203                 | .0050/127                 | .059/1.50                 |                              | .0010/25                  | .004/102                                |
| <b>2830-5</b>                 | .0075/191                | .0120/305                 | .0150/381                | .0080/203                | .0090/229                 | .0050/127                 | .059/1.50                 |                              | .0013/33                  | .005/127                                |
| <b>2830-6</b>                 | .0090/229                | .0120/305                 | .0180/457                | .0090/229                | .0090/229                 | .0060/152                 | .059/1.50                 |                              | .0016/41                  | .006/152                                |
| <b>2830-7</b>                 | .0105/267                | .0120/305                 | .0210/533                | .0090/229                | .0090/229                 | .0060/152                 | .059/1.50                 |                              | .0018/46                  | .007/178                                |
| <b>2830-8</b>                 | .0120/305                | .0120/305                 | .0240/610                | .0050/127                | .0090/229                 | .0060/152                 | .059/1.50                 |                              | .0020/51                  | .008/203                                |
| <b>2830-10</b>                | .0140/356                | .0150/381                 | .0300/762                | .0100/254                | .0100/254                 | .0060/152                 | .077/1.96                 | 3/32                         | .0025/64                  | .010/254                                |
| <b>2830-12</b>                | .0160/406                | .0180/457                 | .0360/914                | .0100/254                | .0110/279                 | .0070/178                 | .110/2.80                 | 1/8                          | .0030/76                  | .012/305                                |
| <b>2830-15</b>                | .0200/508                | .0200/508                 | .0450/1143               | .0100/254                | .0120/305                 | .0080/203                 | .110/2.80                 |                              | .0038/97                  | .015/381                                |
| <b>2830-20</b>                | .0250/635                | .0250/635                 | .0600/1524               | .0100/254                | .0120/305                 | .0080/203                 | .118/3.00                 |                              | .0050/127                 | .020/508                                |

Dimensions in inches unless otherwise specified

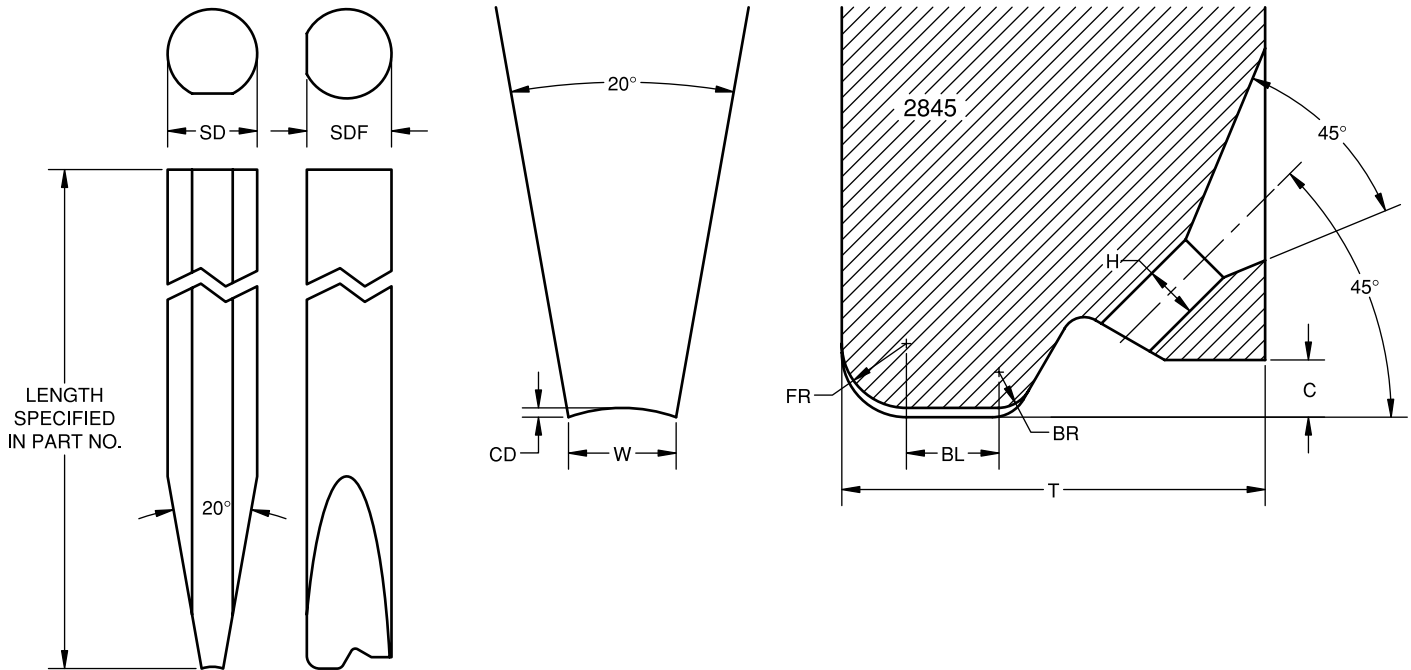

Material:  
 Tungsten Carbide

| SHANK TABLE |   |   |
|-------------|---|---|
| SHANK       | SHANK DIAMETER (SD)<br>in./mm<br>+.0001/.003<br>-.0002/.005 | SHANK DIAMETER<br>FLAT (SDF)<br>in./mm<br>±.0005/.013 |
| 1/16        | 0.0624/1.585  | 0.0460/1.168  |
| 1/16A       | 0.0624/1.585  | 0.0590/1.500  |
| 2mm         | 0.0786/2.000  | 0.0630/1.600  |
| 3/32        | 0.0936/2.377  | 0.0880/2.235  |
| 3mm         | 0.1179/2.995  | 0.0900/2.290  |
| 1/8         | 0.1249/3.172  | 0.1180/3.000  |

Specify: Series/Wire Feed Angle - Wire Diameter - Shank(See Table) - Length

Example:  
 2845-5-1/16A-L  
 2845-12-1/8-1.0

| 2845 SERIES<br>PART<br>NUMBER | H<br>in./μm<br>±.0005/13 | BL<br>in./μm<br>±.0005/13 | W<br>in./μm<br>±.0005/13 | C<br>in./μm<br>±.0005/13 | FR<br>in./μm<br>±.0005/13 | BR<br>in./μm<br>±.0005/13 | T<br>in./mm<br>±.001/.025 | MINIMUM<br>SHANK<br>DIAMETER | CD<br>in./μm<br>±.0005/13 | SUGGESTED<br>WIRE<br>DIAMETER<br>in./μm |
|-------------------------------|--------------------------|---------------------------|--------------------------|--------------------------|---------------------------|---------------------------|---------------------------|------------------------------|---------------------------|---|
| 2845-3                        | .0045/114                | .0070/178                 | .0100/254                | .0050/127                | .0060/152                 | .0040/102                 | .045/1.14                 | 1/16                         | .0008/20                  | .003/76                                 |
| 2845-4                        | .0060/152                | .0100/254                 | .0120/305                | .0070/178                | .0080/203                 | .0050/127                 | .059/1.50                 | 1/16A                        | .0010/25                  | .004/102                                |
| 2845-5                        | .0075/191                | .0120/305                 | .0150/381                | .0080/203                | .0090/229                 | .0050/127                 | .059/1.50                 |                              | .0013/33                  | .005/127                                |
| 2845-6                        | .0090/229                | .0120/305                 | .0180/457                | .0090/229                | .0090/229                 | .0060/152                 | .059/1.50                 |                              | .0016/41                  | .006/152                                |
| 2845-7                        | .0105/267                | .0120/305                 | .0210/533                | .0090/229                | .0090/229                 | .0060/152                 | .059/1.50                 |                              | .0018/46                  | .007/178                                |
| 2845-8                        | .0120/305                | .0120/305                 | .0240/610                | .0050/127                | .0090/229                 | .0060/152                 | .059/1.50                 |                              | .0020/51                  | .008/203                                |
| 2845-10                       | .0140/356                | .0150/381                 | .0300/762                | .0100/254                | .0100/254                 | .0060/152                 | .088/2.23                 | 3/32                         | .0025/64                  | .010/254                                |
| 2845-12                       | .0160/406                | .0180/457                 | .0360/914                | .0100/254                | .0110/279                 | .0070/178                 | .088/2.23                 |                              | .0030/76                  | .012/305                                |
| 2845-15                       | .0200/508                | .0200/508                 | .0450/1143               | .0100/254                | .0120/305                 | .0080/203                 | .088/2.23                 |                              | .0038/97                  | .015/381                                |
| 2845-20                       | .0250/635                | .0250/635                 | .0600/1524               | .0100/254                | .0120/305                 | .0080/203                 | .118/3.00                 | 1/8                          | .0050/127                 | .020/508                                |

Dimensions in inches unless otherwise specified

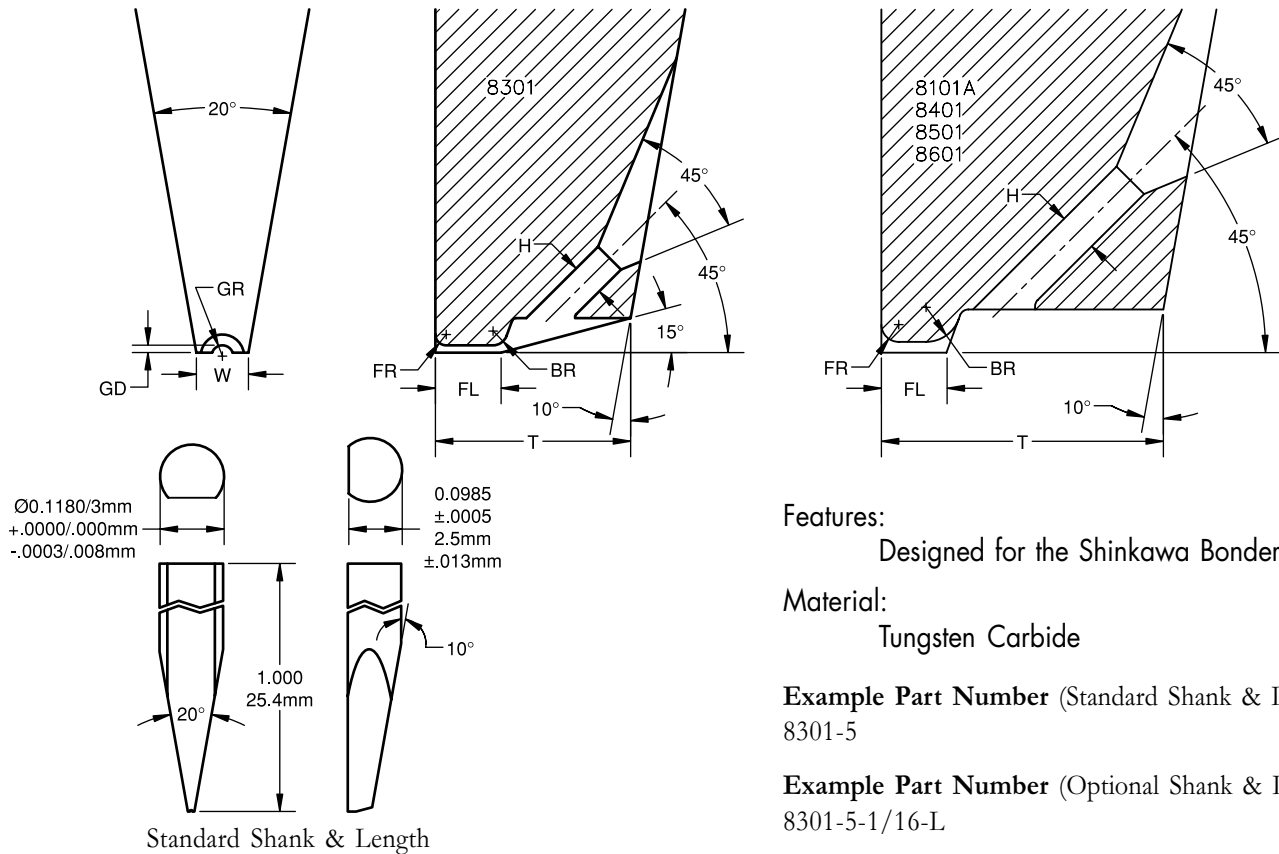

Features:  
 Designed for the Shinkawa Bonder

Material:  
 Tungsten Carbide

Example Part Number (Standard Shank & Length):  
 8301-5

Example Part Number (Optional Shank & Length):  
 8301-5-1/16-L

Standard Shank & Length

| PART NUMBER | FL<br>in./ $\mu$ m<br>$\pm$ .0010/25 | FR<br>in./ $\mu$ m<br>$\pm$ .0005/13 | BR<br>in./ $\mu$ m<br>$\pm$ .0005/13 | H<br>in./ $\mu$ m<br>$\pm$ .0005/13 | W<br>in./ $\mu$ m<br>$\pm$ .0010/25 | GR<br>in./ $\mu$ m<br>$\pm$ .0002/5 | GD<br>in./ $\mu$ m<br>$\pm$ .0002/5 | T<br>in./ $\mu$ m<br>$\pm$ .0020/51 | WIRE DIAMETER<br>in./ $\mu$ m |
|-------------|--------------------------------------|--------------------------------------|--------------------------------------|-------------------------------------|-------------------------------------|-------------------------------------|-------------------------------------|-------------------------------------|-------------------------------|
| 8301-1      | .0080/203                            | .0020/51                             | .0027/69                             | .0060/152                           | .0100/254                           | .0020/51                            | .0013/33                            | .0360/914                           | .0040/102                     |
| 8301-4      | .0120/305                            | .0020/51                             | .0027/69                             | .0060/152                           | .0100/254                           | .0020/51                            | .0013/33                            | .0400/1016                          |                               |
| 8301-2      | .0100/254                            | .0025/64                             | .0033/84                             | .0075/190                           | .0120/305                           | .0025/64                            | .0017/43                            | .0400/1016                          | .0050/127                     |
| 8301-5      | .0150/381                            | .0025/64                             | .0033/84                             | .0075/190                           | .0120/305                           | .0025/64                            | .0017/43                            | .0450/1143                          |                               |
| 8501-1      | .0150/381                            | .0040/102                            | .0080/203                            | .0090/229                           | .0200/508                           | .0030/76                            | .0025/64                            | .0650/1651                          |                               |
| 8601-1      | .0175/445                            | .0040/102                            | .0080/203                            | .0090/229                           | .0200/508                           | .0030/76                            | .0025/64                            | .0650/1651                          | .0060/152                     |
| 8301-3      | .0120/305                            | .0030/76                             | .0040/102                            | .0090/229                           | .0150/381                           | .0030/76                            | .0020/51                            | .0440/1118                          |                               |
| 8301-6      | .0180/457                            | .0030/76                             | .0040/102                            | .0090/229                           | .0150/381                           | .0030/76                            | .0020/51                            | .0500/1270                          |                               |
| 8101A-3     | .0140/356                            | .0040/102                            | .0100/254                            | .0110/279                           | .0240/610                           | .0040/102                           | .0030/76                            | .0650/1651                          | .0080/203                     |
| 8401-3      | .0176/447                            | .0040/102                            | .0100/254                            | .0110/279                           | .0240/610                           | .0040/102                           | .0030/76                            | .0690/1753                          |                               |
| 8501-3      | .0263/600                            | .0040/102                            | .0100/254                            | .0145/368                           | .0240/610                           | .0040/102                           | .0030/76                            | .0820/2083                          |                               |
| 8101A-4     | .0180/457                            | .0050/127                            | .0120/305                            | .0140/356                           | .0300/762                           | .0050/127                           | .0040/102                           | .0710/1803                          | .0100/254                     |
| 8401-4      | .0220/560                            | .0050/127                            | .0120/305                            | .0140/356                           | .0300/762                           | .0050/127                           | .0040/102                           | .0750/1905                          |                               |
| 8501-4      | .0300/762                            | .0050/127                            | .0120/305                            | .0180/457                           | .0300/762                           | .0050/127                           | .0040/102                           | .0900/2286                          |                               |
| 8101A-5     | .0210/533                            | .0060/152                            | .0140/356                            | .0170/432                           | .0300/762                           | .0060/152                           | .0050/127                           | .0790/2006                          | .0120/305                     |
| 8401-5      | .0264/671                            | .0060/152                            | .0140/356                            | .0170/432                           | .0300/762                           | .0060/152                           | .0050/127                           | .0840/2134                          |                               |
| *8501-5     | .0360/914                            | .0060/152                            | .0140/356                            | .0216/549                           | .0300/762                           | .0060/152                           | .0050/127                           | .1100/2794                          |                               |
| 8101A-6     | .0250/635                            | .0070/178                            | .0160/406                            | .0190/483                           | .0300/762                           | .0070/178                           | .0060/152                           | .0820/2082                          | .0138/351                     |
| 8401-6      | .0300/762                            | .0070/178                            | .0160/406                            | .0190/483                           | .0300/762                           | .0070/178                           | .0060/152                           | .0870/2210                          |                               |
| *8501-6     | .0414/1052                           | .0070/178                            | .0160/406                            | .0290/737                           | .0300/762                           | .0070/178                           | .0060/152                           | .1100/2794                          |                               |
| 8101A-7     | .0280/711                            | .0080/203                            | .0170/432                            | .0235/597                           | .0350/889                           | .0080/203                           | .0065/165                           | .0880/2235                          | .0157/399                     |
| 8401-7      | .0346/879                            | .0080/203                            | .0170/432                            | .0235/597                           | .0350/889                           | .0080/203                           | .0065/165                           | .0950/2413                          |                               |
| 8401-7A     | .0460/1168                           | .0080/203                            | .0170/432                            | .0235/597                           | .0350/889                           | .0080/203                           | .0065/165                           | .0950/2413                          |                               |
| *8801-7     | .0470/1194                           | .0080/203                            | .0170/432                            | .0280/711                           | .0500/1270                          | .0080/203                           | .0065/165                           | .1500/3810                          | .0200/508                     |
| *8101A-8    | .0360/914                            | .0100/254                            | .0180/457                            | .0300/762                           | .0350/889                           | .0100/254                           | .0087/220                           | .1100/2794                          |                               |
| *8401-8     | .0440/1118                           | .0100/254                            | .0180/457                            | .0300/762                           | .0350/889                           | .0100/254                           | .0087/220                           | .1060/2692                          |                               |
| *8801-8     | .0500/1270                           | .0100/254                            | .0180/457                            | .0360/914                           | .0500/1270                          | .0100/254                           | .0087/220                           | .1500/3810                          |                               |

\*SDF = 0.110/2.79mm

Dimensions in inches unless otherwise specified

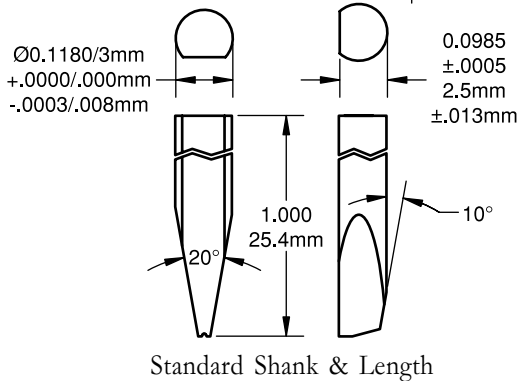
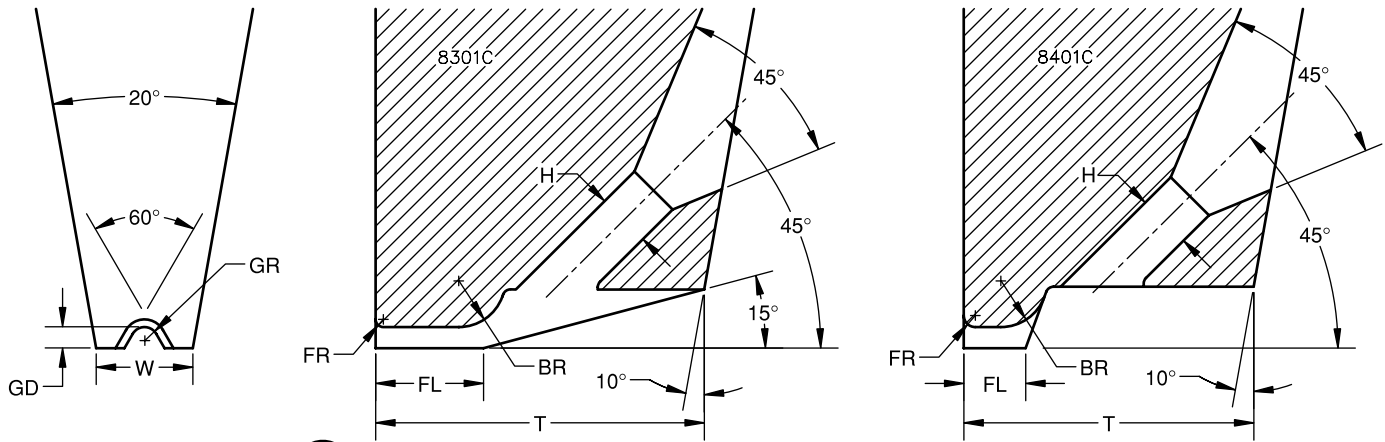

Features:  
 Designed for the Shinkawa Bonder

Material:  
 Tungsten Carbide

Example Part Number (Standard Shank & Length):  
 8301C-5

Example Part Number (Optional Shank & Length):  
 8301C-5-1/16-L

| PART NUMBER | BL                             | FL                             | FR                             | BR                             | H                              | W                              | GR                            | GD                            | T                              | WIRE DIAMETER |
|-------------|--------------------------------|--------------------------------|--------------------------------|--------------------------------|--------------------------------|--------------------------------|-------------------------------|-------------------------------|--------------------------------|---------------|
|             | in./ $\mu$ m<br>$\pm$ .0010/25 | in./ $\mu$ m<br>$\pm$ .0010/25 | in./ $\mu$ m<br>$\pm$ .0005/13 | in./ $\mu$ m<br>$\pm$ .0005/13 | in./ $\mu$ m<br>$\pm$ .0005/13 | in./ $\mu$ m<br>$\pm$ .0010/25 | in./ $\mu$ m<br>$\pm$ .0002/5 | in./ $\mu$ m<br>$\pm$ .0002/5 | in./ $\mu$ m<br>$\pm$ .0020/51 |               |
| 8301C-19    | .0040/102                      | .0080/203                      | .0020/51                       | .0048/122                      | .0060/152                      | .0150/381                      | .0014/36                      | .0022/56                      | .0290/737                      | .0040/102     |
| 8301C-10    | .0060/152                      | .0100/254                      | .0020/51                       | .0048/122                      | .0060/152                      | .0150/381                      | .0014/36                      | .0022/56                      | .0310/787                      |               |
| 8301C-1     | .0088/224                      | .0130/330                      | .0020/51                       | .0048/122                      | .0060/152                      | .0150/381                      | .0014/36                      | .0022/56                      | .0340/864                      | .0050/127     |
| 8301C-20    | .0050/127                      | .0090/229                      | .0020/51                       | .0060/152                      | .0075/190                      | .0150/381                      | .0018/46                      | .0028/71                      | .0380/965                      |               |
| 8301C-11    | .0075/190                      | .0120/305                      | .0020/51                       | .0060/152                      | .0075/190                      | .0150/381                      | .0018/46                      | .0028/71                      | .0400/1020                     | .0060/152     |
| 8301C-2     | .0110/279                      | .0150/381                      | .0020/51                       | .0060/152                      | .0075/190                      | .0150/381                      | .0018/46                      | .0028/71                      | .0430/1090                     |               |
| 8301C-21    | .0060/152                      | .0110/279                      | .0030/76                       | .0072/183                      | .0090/229                      | .0150/381                      | .0021/53                      | .0033/84                      | .0460/1168                     | .0080/203     |
| 8301C-12    | .0090/229                      | .0140/356                      | .0030/76                       | .0072/183                      | .0090/229                      | .0150/381                      | .0021/53                      | .0033/84                      | .0490/1245                     |               |
| 8301C-3     | .0132/335                      | .0180/457                      | .0030/76                       | .0072/183                      | .0090/229                      | .0150/381                      | .0021/53                      | .0033/84                      | .0530/1346                     | .0100/254     |
| 8301C-22    | .0080/203                      | .0140/356                      | .0030/76                       | .0096/244                      | .0110/279                      | .0250/635                      | .0028/71                      | .0044/112                     | .0570/1448                     |               |
| 8301C-13    | .0120/305                      | .0180/457                      | .0030/76                       | .0096/244                      | .0110/279                      | .0250/635                      | .0028/71                      | .0044/112                     | .0610/1550                     | .0120/305     |
| 8301C-4     | .0176/447                      | .0230/584                      | .0030/76                       | .0096/244                      | .0110/279                      | .0250/635                      | .0028/71                      | .0044/112                     | .0670/1701                     |               |
| 8301C-23    | .0100/254                      | .0160/406                      | .0030/76                       | .0120/305                      | .0140/356                      | .0250/635                      | .0035/89                      | .0055/140                     | .0730/1854                     | .0140/360     |
| 8301C-14    | .0150/381                      | .0210/533                      | .0030/76                       | .0120/305                      | .0140/356                      | .0250/635                      | .0035/89                      | .0055/140                     | .0780/1981                     |               |
| 8301C-5     | .0220/559                      | .0280/711                      | .0030/76                       | .0120/305                      | .0140/356                      | .0250/635                      | .0035/89                      | .0055/140                     | .0850/2159                     | .0160/406     |
| 8401C-4     | .0100/254                      | .0160/406                      | .0030/76                       | .0120/305                      | .0140/356                      | .0300/762                      | .0035/89                      | .0055/140                     | .0750/1905                     |               |
| 8401C-14    | .0150/381                      | .0210/533                      | .0030/76                       | .0120/305                      | .0140/356                      | .0300/762                      | .0035/89                      | .0055/140                     | .0880/2235                     | .0200/508     |
| 8401C-5     | .0120/305                      | .0180/457                      | .0030/76                       | .0140/356                      | .0170/432                      | .0300/762                      | .0042/107                     | .0066/168                     | .0840/2134                     |               |
| 8401C-15    | .0180/457                      | .0240/610                      | .0030/76                       | .0140/356                      | .0170/432                      | .0300/762                      | .0042/107                     | .0066/168                     | .0950/2413                     | .0140/360     |
| 8401C-6     | .0140/356                      | .0200/508                      | .0030/76                       | .0160/406                      | .0190/483                      | .0300/762                      | .0049/125                     | .0077/196                     | .0870/2210                     |               |
| *8401C-16   | .0210/533                      | .0270/686                      | .0030/76                       | .0160/406                      | .0190/483                      | .0300/762                      | .0049/125                     | .0077/196                     | .1100/2794                     | .0160/406     |
| 8401C-7     | .0160/406                      | .0230/584                      | .0040/102                      | .0170/432                      | .0240/610                      | .0350/889                      | .0056/142                     | .0088/224                     | .0950/2413                     |               |
| *8401C-17   | .0240/610                      | .0310/787                      | .0040/102                      | .0170/432                      | .0240/610                      | .0350/889                      | .0056/142                     | .0088/224                     | .1100/2794                     | .0200/508     |
| *8401C-8    | .0200/508                      | .0270/686                      | .0040/102                      | .0180/457                      | .0300/762                      | .0350/889                      | .0070/178                     | .0110/279                     | .1100/2794                     |               |
| *8401C-18   | .0300/762                      | .0370/940                      | .0040/102                      | .0180/457                      | .0300/762                      | .0350/889                      | .0070/178                     | .0110/279                     | .1100/2794                     |               |

\*SDF = 0.110/2.79mm

Dimensions in inches unless otherwise specified

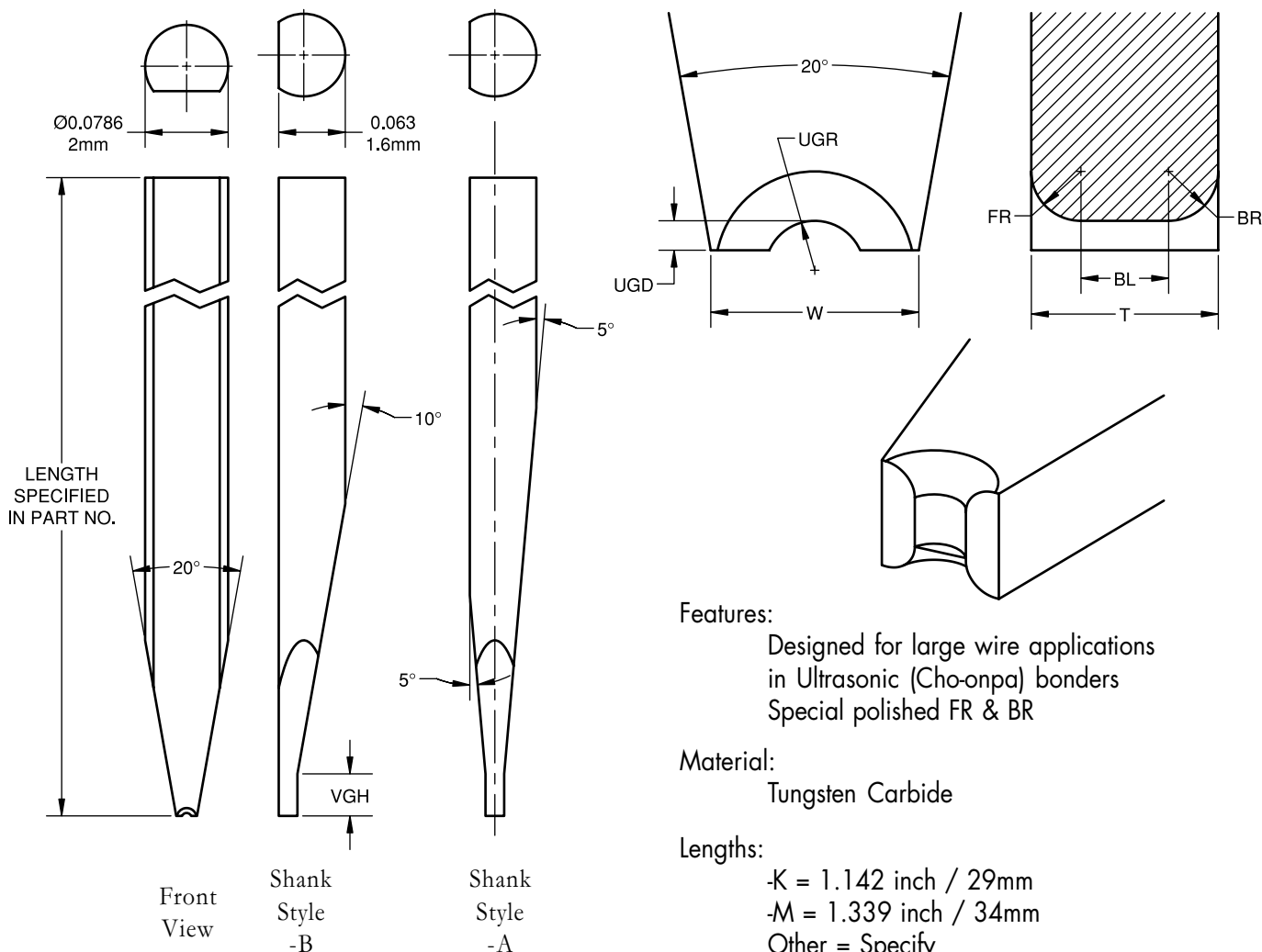

**Features:**

Designed for large wire applications  
 in Ultrasonic (Cho-onpa) bonders  
 Special polished FR & BR

**Material:**

Tungsten Carbide

**Lengths:**

-K = 1.142 inch / 29mm  
 -M = 1.339 inch / 34mm  
 Other = Specify

**Specify:**

Series (no-hole design) - U-Groove - Wire Size( $\mu$ m) - Designation - Shank Style - Tool Length

**Example:**

8236-UG-200-1-A-K

| DASH NUMBER | T in./ $\mu$ m | F in./ $\mu$ m | FR & BR in./ $\mu$ m | UGR in./ $\mu$ m | UGD in./ $\mu$ m | W in./ $\mu$ m | VGH in./ $\mu$ m |
|-------------|----------------|----------------|----------------------|------------------|------------------|----------------|------------------|
| -100-1      | .0098/250      | .0051/130      | .0024/60             | .0024/60         | .0014/36         | .0098/250      | .0400/1016       |
| -125-1      | .0118/300      | .0059/150      | .0030/76             | .0030/76         | .0017/43         | .0118/300      | .0400/1016       |
| -125-2      | .0128/325      | .0068/173      | .0030/76             | .0030/76         | .0017/43         | .0118/300      | .0400/1016       |
| -125-3      | .0138/350      | .0078/198      | .0030/76             | .0030/76         | .0017/43         | .0118/300      | .0400/1016       |
| -125-4      | .0148/375      | .0088/224      | .0030/76             | .0030/76         | .0017/43         | .0118/300      | .0400/1016       |
| -150-1      | .0138/350      | .0068/173      | .0035/88             | .0035/88         | .0021/53         | .0138/350      | .0400/1016       |
| -175-1      | .0157/400      | .0075/190      | .0041/104            | .0041/104        | .0024/60         | .0157/400      | .0400/1016       |
| -200-1      | .0177/450      | .0083/210      | .0047/120            | .0047/120        | .0028/71         | .0197/500      | .0400/1016       |
| -250-1      | .0217/550      | .0098/250      | .0059/150            | .0059/150        | .0035/88         | .0217/550      | .0600/1524       |
| -300-1      | .0256/650      | .0114/290      | .0071/180            | .0071/180        | .0047/120        | .0236/600      | .0600/1524       |
| -350-1      | .0299/760      | .0134/340      | .0083/210            | .0083/210        | .0055/140        | .0276/700      | .0600/1524       |
| -400-1      | .0339/860      | .0150/380      | .0094/240            | .0094/240        | .0063/160        | .0315/800      | .0600/1524       |
| -450-1      | .0390/990      | .0177/450      | .0106/270            | .0106/270        | .0071/180        | .0354/900      | .0600/1524       |
| -500-1      | .0433/1100     | .0197/500      | .0118/300            | .0118/300        | .0079/200        | .0394/1000     | .0600/1524       |

*Dimensions in inches unless otherwise specified*

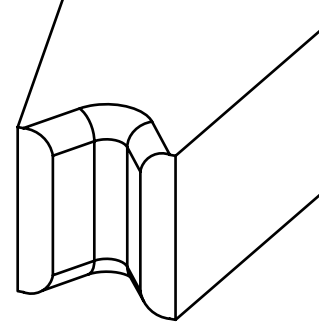
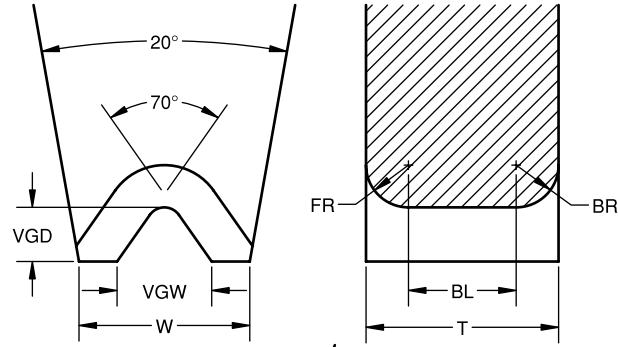
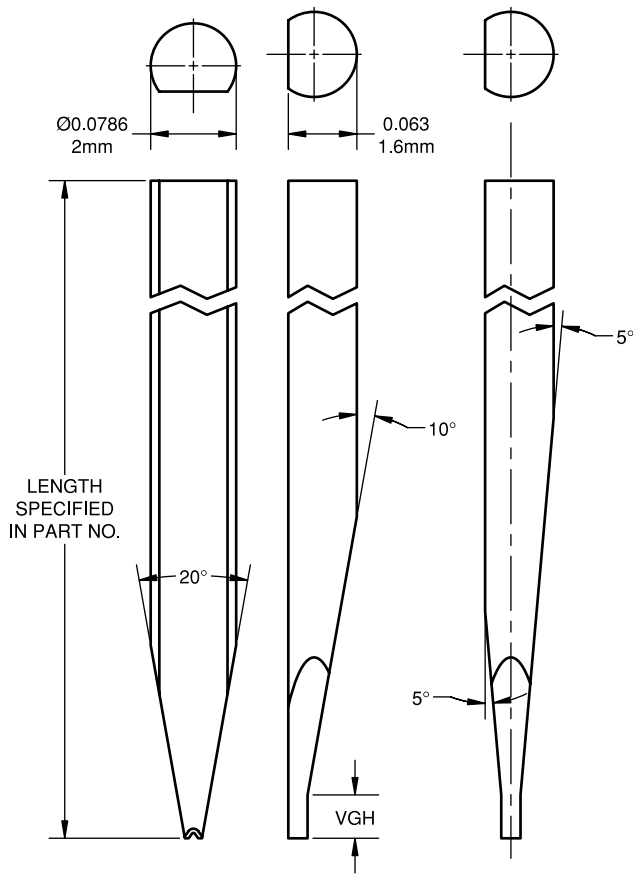

**Features:**

Designed for large wire applications  
 in Ultrasonic (Cho-onpa) bonders  
 Special polished FR & BR

**Material:**

Tungsten Carbide

**Lengths:**

-K = 1.142 inch / 29mm  
 -M = 1.339 inch / 34mm  
 Other = Specify

Front  
View

Shank  
Style  
-B

Shank  
Style  
-A

**Specify:**

Series (no-hole design) - V-Groove - Wire Size( $\mu\text{m}$ ) - FR/BR Ratio (% of wire dia.) - Shank Style - Tool Length

**Example:**

8236-VE-200-30-A-K

| DASH NUMBER | T in./ $\mu\text{m}$ | F in./ $\mu\text{m}$ | FR & BR in./ $\mu\text{m}$ | VGW in./ $\mu\text{m}$ | W in./ $\mu\text{m}$ | VGH in./ $\mu\text{m}$ |
|-------------|----------------------|----------------------|----------------------------|------------------------|----------------------|------------------------|
| -100-30     | .0098/250            | .0074/188            | .0012/30                   | .0043/110              | .0079/200            | .0400/1016             |
| -100-50     | .0098/250            | .0058/147            | .0020/51                   | .0043/110              | .0079/200            | .0400/1016             |
| -125-30     | .0118/300            | .0088/224            | .0015/38                   | .0054/138              | .0098/250            | .0400/1016             |
| -125-50     | .0118/300            | .0068/173            | .0025/64                   | .0054/138              | .0098/250            | .0400/1016             |
| -150-30     | .0138/350            | .0102/260            | .0018/45                   | .0065/165              | .0118/300            | .0400/1016             |
| -150-50     | .0138/350            | .0078/198            | .0030/76                   | .0065/165              | .0118/300            | .0400/1016             |
| -200-30     | .0177/450            | .0129/330            | .0024/60                   | .0087/220              | .0157/400            | .0400/1016             |
| -200-50     | .0177/450            | .0099/252            | .0039/100                  | .0087/220              | .0157/400            | .0400/1016             |
| -250-50     | .0217/550            | .0119/302            | .0049/125                  | .0108/275              | .0197/500            | .0600/1524             |
| -300-50     | .0256/650            | .0138/350            | .0059/150                  | .0130/330              | .0236/600            | .0600/1524             |
| -350-50     | .0299/760            | .0161/410            | .0069/175                  | .0152/385              | .0276/700            | .0600/1524             |
| -380-50     | .0323/820            | .0173/440            | .0075/191                  | .0165/418              | .0299/760            | .0600/1524             |
| -400-50     | .0343/870            | .0185/470            | .0079/200                  | .0173/440              | .0315/800            | .0600/1524             |
| -450-50     | .0390/990            | .0212/540            | .0089/225                  | .0195/495              | .0354/900            | .0600/1524             |
| -500-50     | .0433/1100           | .0237/600            | .0098/250                  | .0217/550              | .0394/1000           | .0600/1524             |

*Dimensions in inches unless otherwise specified*

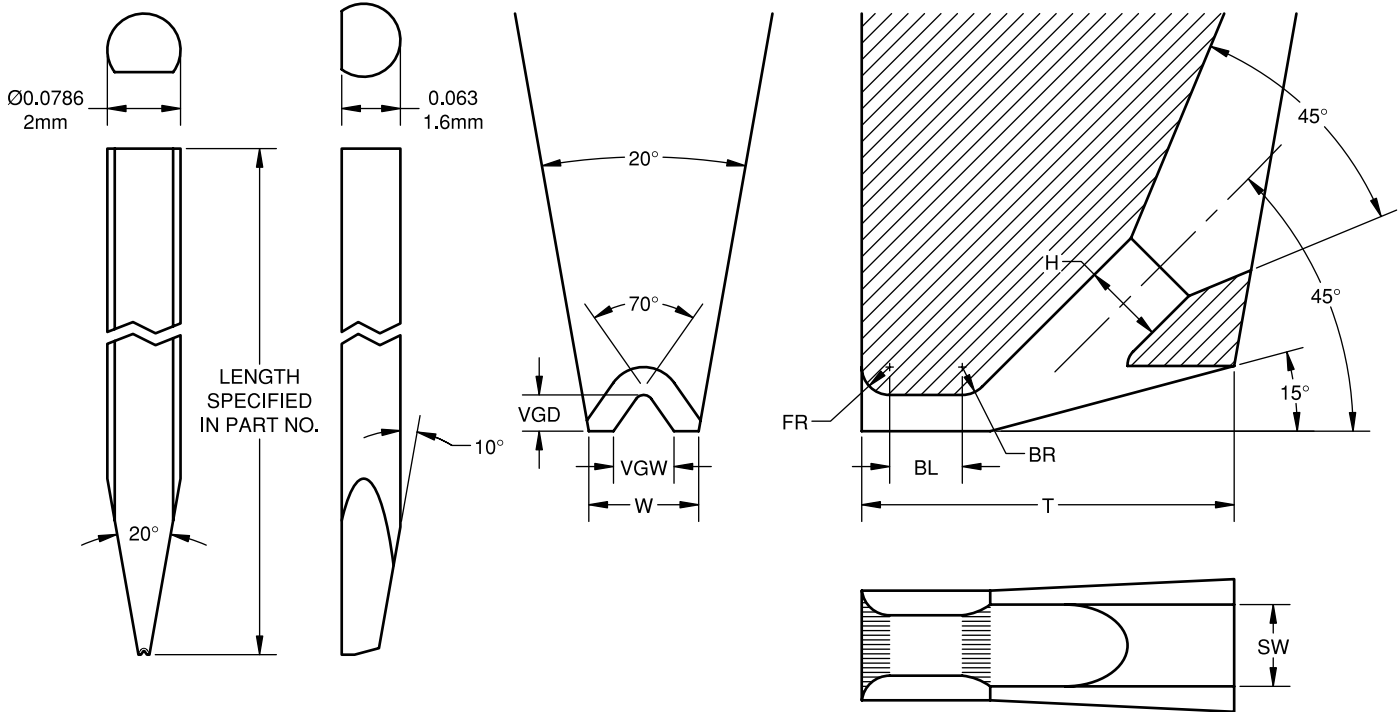

**Features:**

- Designed for large wire applications in Ultrasonic (Cho-onpa) bonders
- Special polished FR & BR
- Special heavy hole polish

**Material:**

Tungsten Carbide

**Lengths:**

- K = 1.142 inch / 29mm
- M = 1.339 inch / 34mm
- Other = Specify

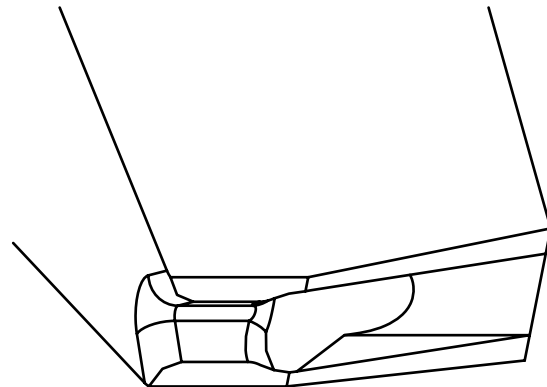

**Specify:**

Series (45° wire feed angle) - V-Groove - Wire Size(μm)/Designation - FR/BR Ratio (% of wire dia.) - Tool Length

**Example:**

8245-VE-150N-50-K

| DASH NUMBER | T<br>in./μm | FL<br>in./μm | BL<br>in./μm | FR & BR<br>in./μm | H<br>in./μm | W<br>in./μm | VGW<br>in./μm |
|-------------|-------------|--------------|--------------|-------------------|-------------|-------------|---------------|
| -100N-50    | .0290/737   | .0098/250    | .0058/150    | .0020/51          | .0059/150   | .0079/200   | .0043/109     |
| -125N-50    | .0360/914   | .0118/300    | .0068/174    | .0025/64          | .0074/188   | .0098/250   | .0054/137     |
| -150N-50    | .0400/1016  | .0138/350    | .0078/198    | .0030/76          | .0088/224   | .0118/300   | .0065/165     |
| -200N-50    | .0540/1372  | .0157/400    | .0079/200    | .0039/100         | .0118/300   | .0157/400   | .0087/221     |
| -250N-50    | .0630/1600  | .0197/500    | .0099/252    | .0049/125         | .0148/375   | .0197/500   | .0108/274     |
| -300N-50    | .0630/1600  | .0236/600    | .0118/300    | .0059/150         | .0177/450   | .0236/600   | .0130/330     |

*Dimensions in inches unless otherwise specified*