

Optional Double Side Relief

Specified in part number

-DSR("W"x"H")

Example:

For a double side relief 0.004 inch wide x 0.010 inch high, specify "-DSR(004x010)"

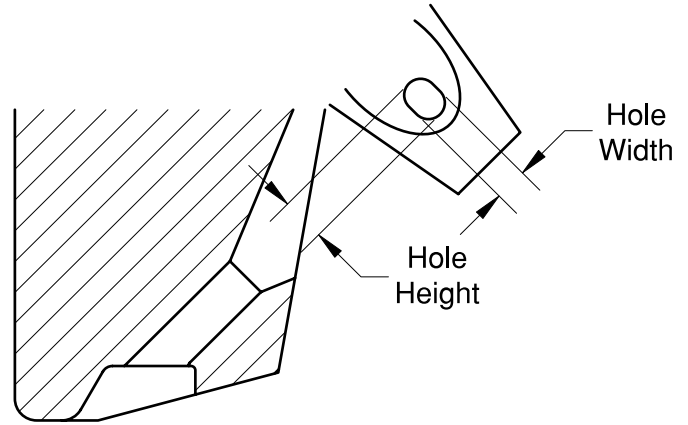

Optional Oval Hole

Specified in part number

Width x Height

Example:

For an oval hole 0.0015 inch wide x 0.0020 inch high, specify "15x20" for hole size in part number (e.g. 2145-15x2015-L-F-CER)

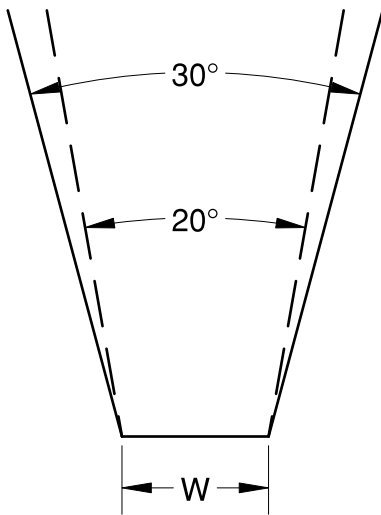

Optional 30° W Angle

Specified in part number

-30DG

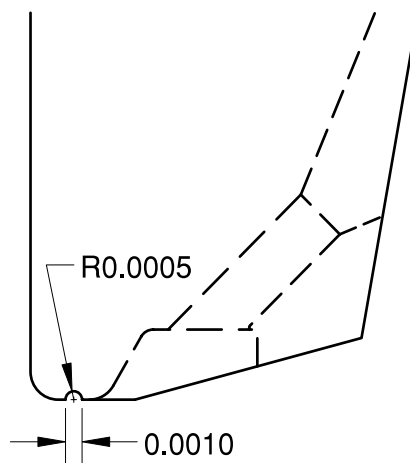

Optional Cross Groove

Specified in part number

-CG

Standard in some series
 Enhances the transfer of ultrasonic energy in situations of poor bondability
 Recommended for flat face gold wire tools

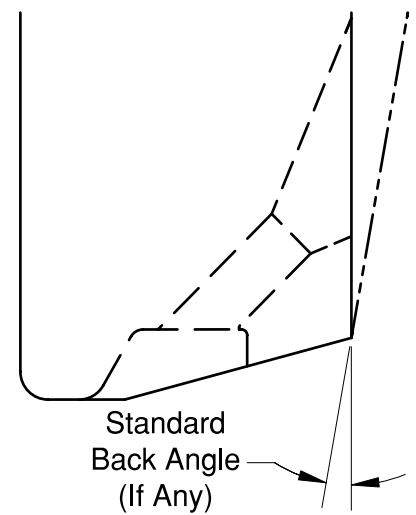

Optional Vertical Back Grind

Specified in part number

-V

Standard in some series
 The vertical back grind is 0.040 inch high

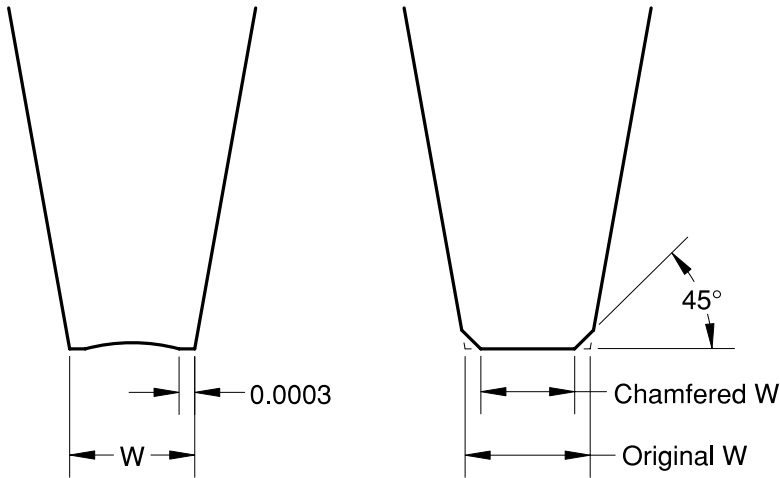

Optional Concave Side Flats

Specified in part number

-CSF

Optional 45° Side Chamfers

Specified in part number

-45SC(W="Chamfered W")

For fine pitch wire bonding

Example part number:

2145-2020-3/4-F-45SC(W=003)-TiC

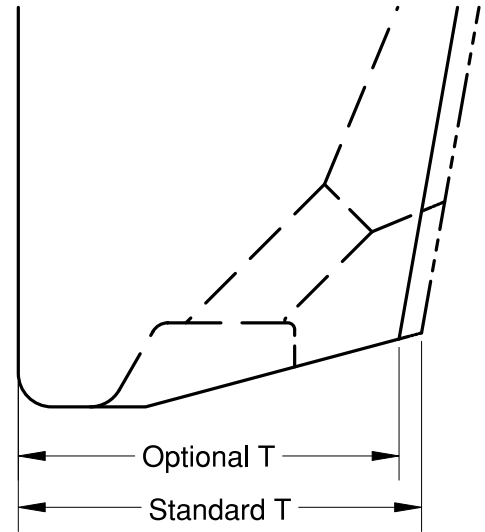

Optional T Size

Specified in part number

-T="Optional T"

For a T=0.010 inch,
 specify "-T=010"

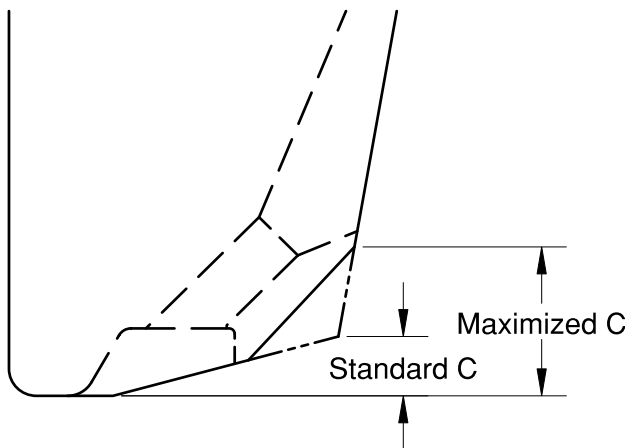

Optional Modified C Dimension

Specified in part number

-MOD C

For maximum rear clearance

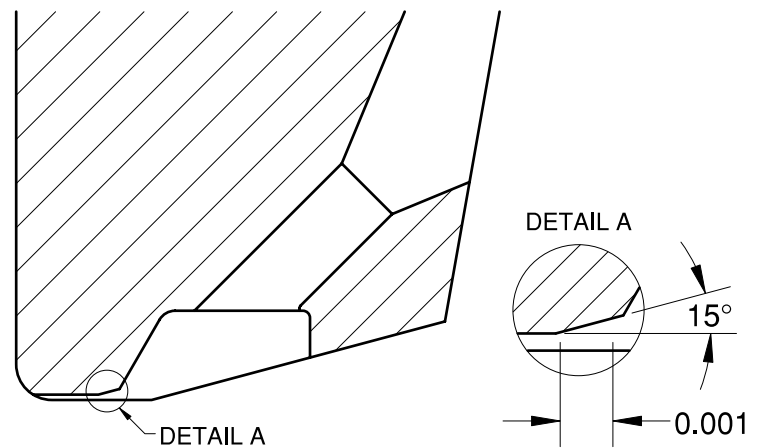

Optional Chamfered Back Radius

Specified in part number

-CBR

Note: The CBR option defaults to 0.0010 in./25µm, CBR(001), unless otherwise specified. For other CBR sizes, specify CBR(0008), CBR(0012), etc.