

Material:

- Tungsten Carbide Standard
- TiC = Titanium Carbide
- BKCR = Cermet Tip
- DT = Diamond Tip

Specify: Series - Face/Outside Radius/Cross Groove Spec. - Length - Options

Example:

1183-06010B-750-TiC-SDF-20D

1183-02008D-437

Options:

- SDF = Tool makes a "+" pattern
- SDFA = Tool makes a "x" pattern
- 20D = 20° Cone Angle (30° standard)
- Bottlenecks may be designed

Lengths:

- 375 = 0.375 in./9.52mm
- 437 = 0.437 in./11.1mm
- 625 = 0.625 in./15.88mm
- 750 = 0.750 in./19.05mm
- 828 = 0.828 in./21.03mm
- 1.0 = 1.000 in./25.4mm
- Other = Specify

| DASH NUMBER | FACE in./ μ m \pm .0002/5 | OR in./ μ m \pm .0002/5 | T 30° in./ μ m \pm .0003/8 | CGR in./ μ m \pm .0001/3 | CGD in./ μ m \pm .0001/3 |
|---------------|---------------------------------------|-------------------------------------|--|--------------------------------------|--------------------------------------|
| 01705D | .0017/43 | .0005/13 | .0024/61 | .0003/8 | .0003/8 |
| 02008D | .0020/51 | .0008/20 | .0032/81 | .0003/8 | .0003/8 |
| 02010B | .0020/51 | .0010/25 | .0035/89 | .0005/13 | .0005/13 |
| 02205D | .0022/56 | .0005/13 | .0030/76 | .0003/8 | .0003/8 |
| 03010B | .0030/76 | .0010/25 | .0045/114 | .0005/13 | .0005/13 |
| 03510B | .0035/89 | .0010/25 | .0050/127 | .0005/13 | .0005/13 |
| 04010B | .0040/102 | .0010/25 | .0055/140 | .0005/13 | .0005/13 |
| 04510B | .0045/114 | .0010/25 | .0060/152 | .0005/13 | .0005/13 |
| 05010B | .0050/127 | .0010/25 | .0065/165 | .0005/13 | .0005/13 |
| 06010B | .0060/152 | .0010/25 | .0075/191 | .0005/13 | .0005/13 |
| 08010B | .0080/203 | .0010/25 | .0095/241 | .0005/13 | .0005/13 |
| 08010C | .0080/203 | .0010/25 | .0095/241 | .0010/25 | .0010/25 |
| 09020C | .0090/229 | .0020/51 | .0121/307 | .0010/25 | .0010/25 |
| 12020C | .0120/305 | .0020/51 | .0151/384 | .0010/25 | .0010/25 |

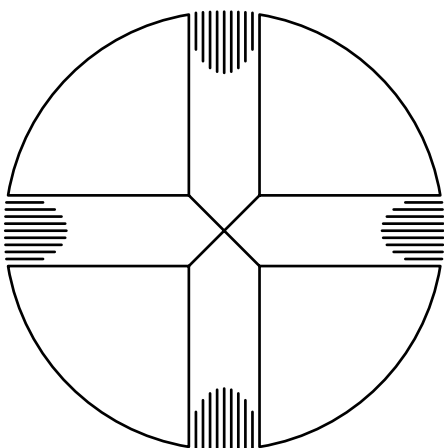
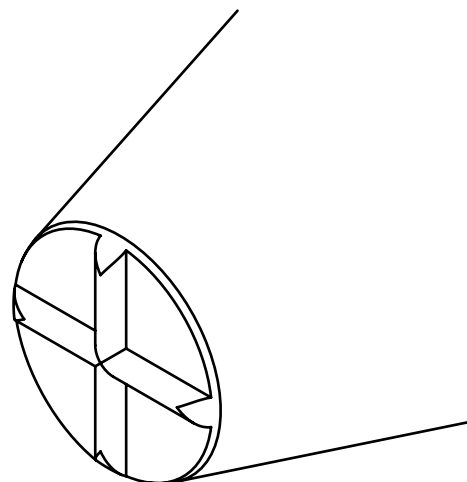
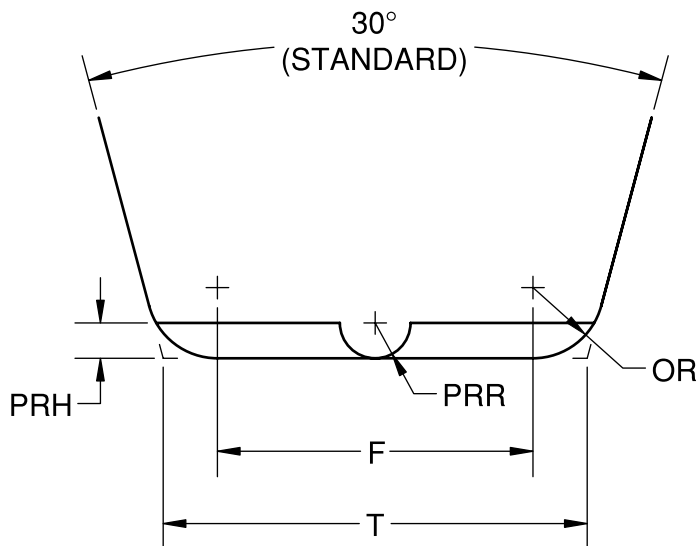

Material:

Tungsten Carbide Standard

-TiC = Titanium Carbide

-BKCR = Cermet Tip

-DT = Diamond Tip

Specify: Series - Face/Outside Radius/Protruding Radius Spec. - Length - Options

Example:

1184-06010B-750-TiC-SDF-20D

1184-02008D-437

Options:

-SDF = Tool makes a "+" pattern

-SDFA = Tool makes a "x" pattern

-20D = 20° Cone Angle (30° standard)

Bottlenecks may be designed

Lengths:

-375 = 0.375 in./9.52mm

-437 = 0.437 in./11.1mm

-625 = 0.625 in./15.88mm

-750 = 0.750 in./19.05mm

-828 = 0.828 in./21.03mm

-1.0 = 1.000 in./25.4mm

Other = Specify

| DASH NUMBER | FACE in./ μ m \pm .0002/5 | OR in./ μ m \pm .0002/5 | T 30° in./ μ m \pm .0003/8 | PRR in./ μ m \pm .0001/3 | PRH in./ μ m \pm .0001/3 |
|---------------|---------------------------------------|-------------------------------------|--|--------------------------------------|--------------------------------------|
| 01705D | .0017/43 | .0005/13 | .0024/61 | .0003/8 | .0003/8 |
| 02008D | .0020/51 | .0008/20 | .0032/81 | .0003/8 | .0003/8 |
| 02205D | .0022/56 | .0005/13 | .0030/76 | .0003/8 | .0003/8 |
| 03008D | .0030/76 | .0008/20 | .0042/107 | .0003/8 | .0003/8 |
| 03510B | .0035/89 | .0010/25 | .0050/127 | .0005/13 | .0005/13 |
| 04510B | .0045/114 | .0010/25 | .0060/152 | .0005/13 | .0005/13 |
| 05010B | .0050/127 | .0010/25 | .0065/165 | .0005/13 | .0005/13 |
| 06010B | .0060/152 | .0010/25 | .0075/191 | .0005/13 | .0005/13 |
| 07010B | .0070/178 | .0010/25 | .0085/216 | .0005/13 | .0005/13 |
| 08010B | .0080/203 | .0010/25 | .0095/241 | .0005/13 | .0005/13 |
| 08010C | .0080/203 | .0010/25 | .0095/241 | .0010/25 | .0010/25 |
| 09020C | .0090/229 | .0020/51 | .0121/307 | .0010/25 | .0010/25 |
| 12020C | .0120/305 | .0020/51 | .0151/384 | .0010/25 | .0010/25 |

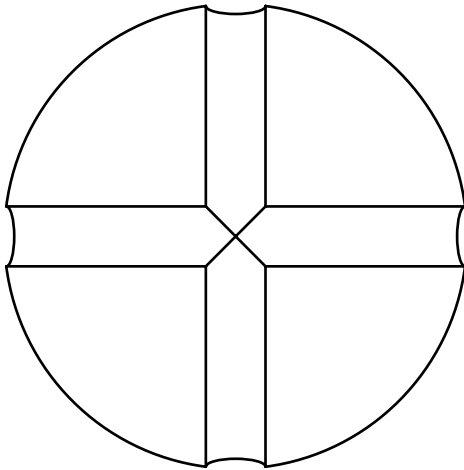
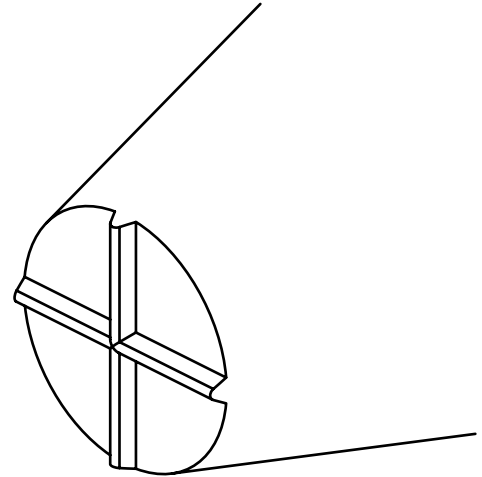
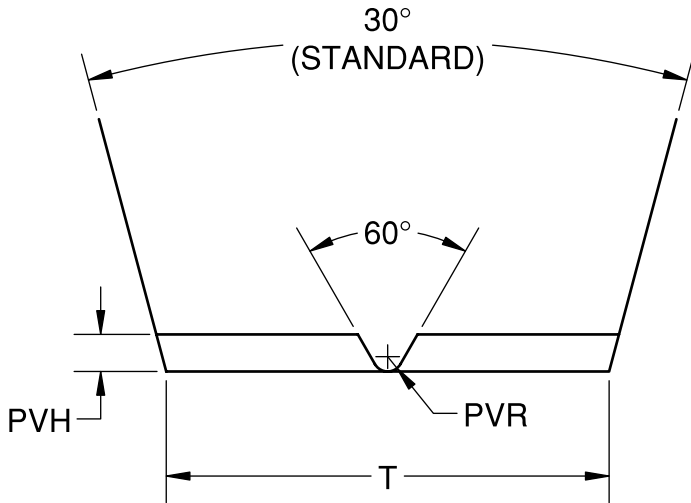

Material:

- Tungsten Carbide Standard
- TiC = Titanium Carbide
- BKCR = Cermet Tip
- DT = Diamond Tip

Specify: Series - Tip Dia./Protruding "V" Height & Radius- Length - Options

Example:

- 1186-060052-437-TiC-SDF
- 1186-095052-750-SDFA-20D

Options:

- SDF = Tool makes a "+" pattern
- SDFA = Tool makes a "x" pattern
- 20D = 20° Cone Angle (30° standard)
- Bottlenecks may be designed

Lengths:

- 375 = 0.375 in./9.52mm
- 437 = 0.437 in./11.1mm
- 625 = 0.625 in./15.88mm
- 750 = 0.750 in./19.05mm
- 828 = 0.828 in./21.03mm
- 1.0 = 1.000 in./25.4mm
- Other = Specify

| DASH NUMBER | T 30° in./μm ±.0003/8 | PVH in./μm ±.0001/3 | PVR in./μm ±.0001/3 |
|-------------|-----------------------------|---------------------------|---------------------------|
| 020020 | .0020/51 | .0002/5 | .0000/0 |
| 032030 | .0032/81 | .0003/8 | .0000/0 |
| 050030 | .0050/127 | .0003/8 | .0000/0 |
| 050032 | .0050/127 | .0003/8 | .0002/5 |
| 050052 | .0050/127 | .0005/13 | .0002/5 |
| 060052 | .0060/152 | .0005/13 | .0002/5 |
| 075052 | .0075/191 | .0005/13 | .0002/5 |
| 095052 | .0095/241 | .0005/13 | .0002/5 |
| 095104 | .0095/241 | .0010/25 | .0004/10 |
| 120104 | .0120/305 | .0010/25 | .0004/10 |
| 150104 | .0150/381 | .0010/25 | .0004/10 |

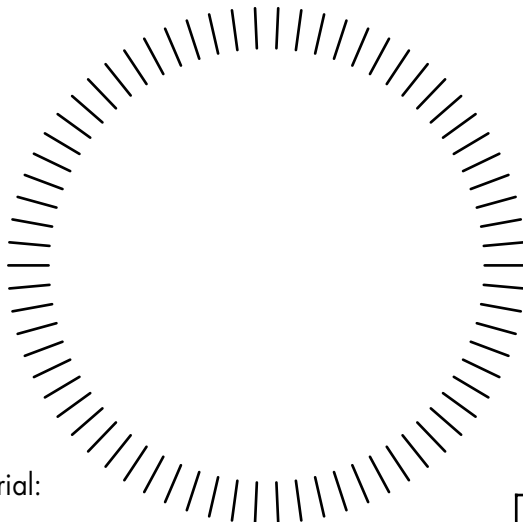
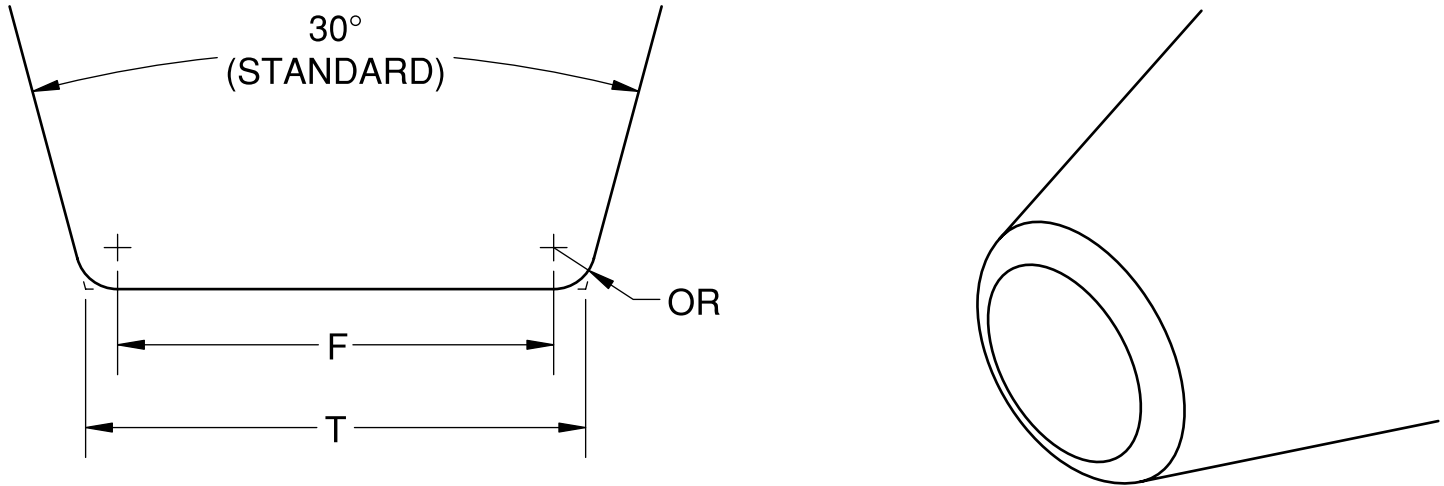

Specify: Series - Face/Outside Radius - Length - Finish - Options
 Example:

1552-090040-750P-20D
 1152-050020-437P-TiC

For -TiC, -BK CER, or -DT use 1152 series

Material:

- 1552 = Standard Ceramic
- 1152 = Tungsten Carbide
- TiC = Titanium Carbide
- BK CER = Cermet Tip
- DT = Diamond Tip

Note: Polished finish not available on DT, as EDM'ed only

Options:

- 20D = 20° Cone Angle (30° standard)
- 15D = 15° Cone Angle
- Bottlenecks may be designed
- P = Polished Finish
- GM = Gaiser Matte Finish
- RF = Rough Matte Finish

Lengths:

- 375 = 0.375 in./9.52mm
- 437 = 0.437 in./11.1mm
- 625 = 0.625 in./15.88mm
- 750 = 0.750 in./19.05mm
- 1.0 = 1.000 in./25.4mm
- Other = Specify

| 1552 CERAMIC | 1152 CARBIDE | FACE in./µm (ref) | OR in./µm ±.0003/8 | T 30° in./µm ±.0003/8 | T 20° in./µm ±.0003/8 |
|--------------|--------------|-------------------|--------------------|-----------------------|-----------------------|
| N/A | -005003 | .0005/13 | .0003/8 | .0010/25 | .0010/25 |
| N/A | -010003 | .0010/25 | .0003/8 | .0015/38 | .0015/38 |
| N/A | -014003 | .0014/36 | .0003/8 | .0018/46 | .0018/46 |
| -030003 | -030003 | .0030/76 | .0003/8 | .0034/86 | .0035/89 |
| -040020 | -040020 | .0040/102 | .0020/51 | .0070/178 | .0074/186 |
| N/A | -050000 | .0050/127 | .0000/0 | .0050/127 | .0050/127 |
| -050003 | -050003 | .0050/127 | .0003/8 | .0054/137 | .0055/140 |
| -050020 | -050020 | .0050/127 | .0020/51 | .0081/206 | .0084/214 |
| -052005 | -052005 | .0052/132 | .0005/13 | .0060/152 | .0060/152 |
| -055003 | -055003 | .0055/140 | .0003/8 | .0060/152 | .0060/152 |
| -080040 | -080040 | .0080/203 | .0040/102 | .0140/356 | .0147/373 |
| -090040 | -090040 | .0090/229 | .0040/102 | .0150/381 | .0157/399 |
| -093025 | -093025 | .0093/236 | .0025/64 | .0130/330 | .0135/343 |
| N/A | -100000 | .0100/254 | .0000/0 | .0100/254 | .0100/254 |
| -100003 | -100003 | .0100/254 | .0003/8 | .0105/267 | .0105/267 |
| -100010 | -100010 | .0100/254 | .0010/25 | .0115/292 | .0117/297 |
| -100040 | -100040 | .0100/254 | .0040/102 | .0160/406 | .0167/424 |
| -120040 | -120040 | .0120/305 | .0040/102 | .0180/457 | .0187/475 |
| -130025 | -130025 | .0130/330 | .0025/64 | .0167/424 | .0172/437 |
| -130040 | -130040 | .0130/330 | .0040/102 | .0190/483 | .0197/500 |
| -150040 | -150040 | .0150/381 | .0040/102 | .0210/533 | .0217/551 |

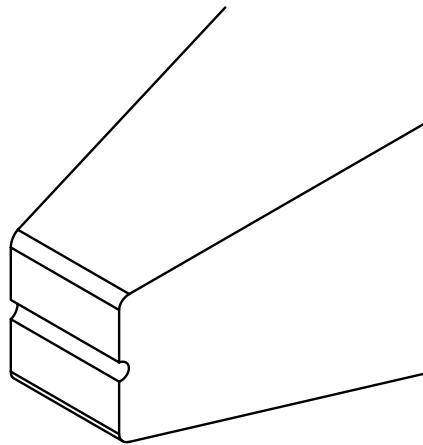
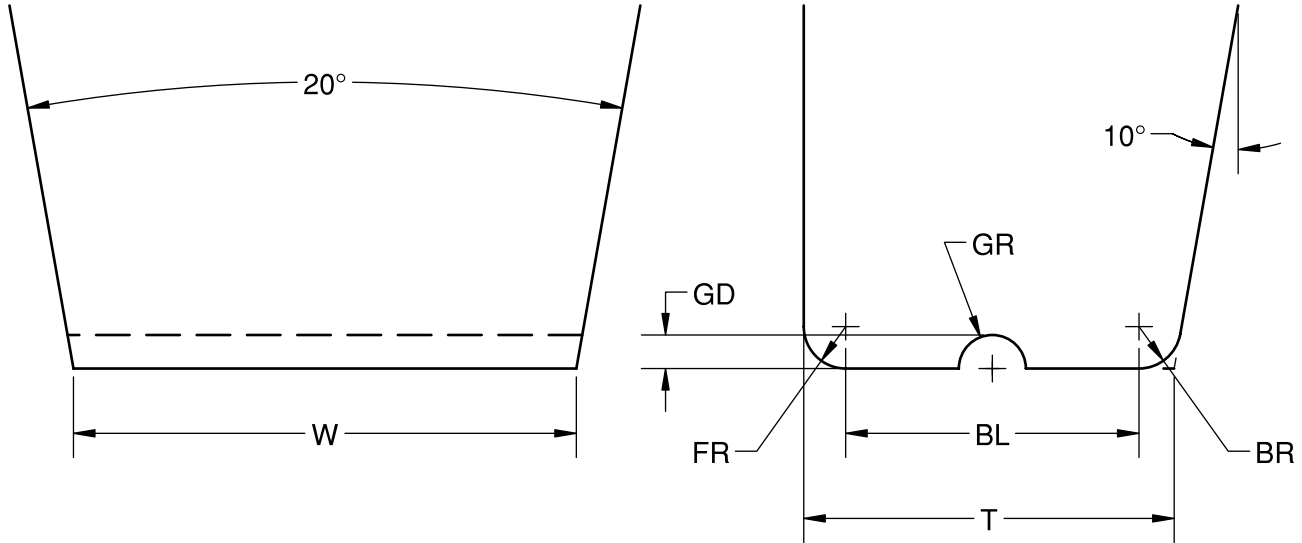

Material:

- Tungsten Carbide Standard
- TiC = Titanium Carbide
- BKCR = Cermet Tip
- DT = Diamond Tip

Options:

See Wedge Modifications

Lengths:

- 375 = 0.375 in./9.52mm
- S = 0.437 in./11.1mm
- 625 = 0.625 in./15.88mm
- 3/4 = 0.750 in./19.05mm
- L = 0.828 in./21.03mm
- 1.0 = 1.000 in./25.4mm
- Other = Specify

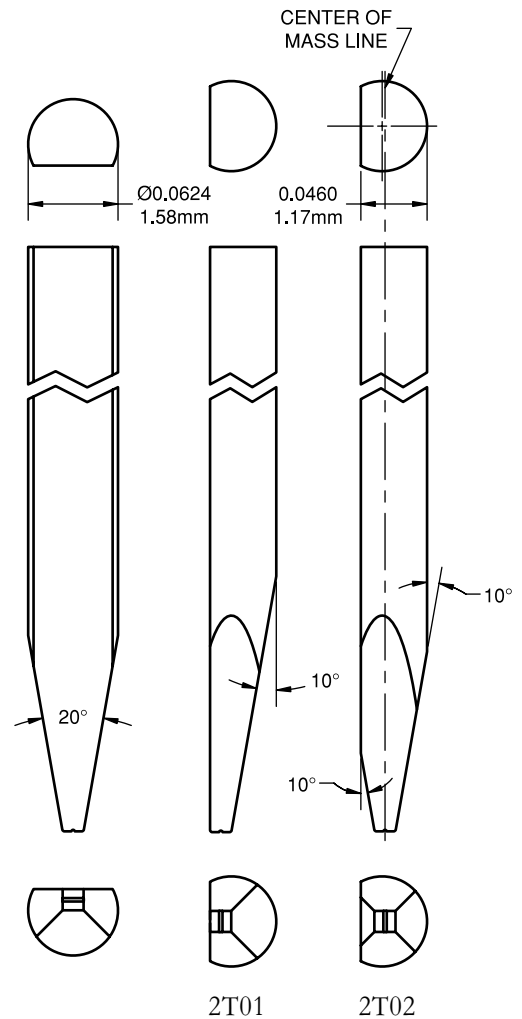

Specify: Series - Bond Length/Bond Foot Width/Radius & Groove Spec. - Shank Length - Options

Example:

2T01-35050C-S-TiC

2T02-45075C-3/4-20D

| DASH NUMBER | BL in./ μ m \pm .0002/5 | W in./ μ m \pm .0002/5 | FR = BR in./ μ m \pm .0002/5 | GR in./ μ m \pm .0001/3 | GD in./ μ m \pm .0001/3 |
|-------------|-------------------------------------|------------------------------------|--|-------------------------------------|-------------------------------------|
| 15025A | .0015/38 | .0025/64 | .0005/13 | .0003/8 | .0003/8 |
| 15035A | .0015/38 | .0035/89 | .0005/13 | .0003/8 | .0003/8 |
| 15040A | .0015/38 | .0040/102 | .0005/13 | .0003/8 | .0003/8 |
| 20020B | .0020/51 | .0020/51 | .0005/13 | .0004/10 | .0004/10 |
| 20025B | .0020/51 | .0025/64 | .0005/13 | .0004/10 | .0004/10 |
| 20030B | .0020/51 | .0030/76 | .0005/13 | .0004/10 | .0004/10 |
| 20035B | .0020/51 | .0035/89 | .0005/13 | .0004/10 | .0004/10 |
| 20040B | .0020/51 | .0040/102 | .0005/13 | .0004/10 | .0004/10 |
| 20050B | .0020/51 | .0050/127 | .0005/13 | .0004/10 | .0004/10 |
| 20080B | .0020/51 | .0080/203 | .0005/13 | .0004/10 | .0004/10 |
| 25020B | .0025/64 | .0020/51 | .0005/13 | .0004/10 | .0004/10 |
| 25030B | .0025/64 | .0030/76 | .0005/13 | .0004/10 | .0004/10 |
| 25040B | .0025/64 | .0040/102 | .0005/13 | .0004/10 | .0004/10 |
| 25050B | .0025/64 | .0050/127 | .0005/13 | .0004/10 | .0004/10 |
| 25067B | .0025/64 | .0067/170 | .0005/13 | .0004/10 | .0004/10 |
| 25080B | .0025/64 | .0080/203 | .0005/13 | .0004/10 | .0004/10 |
| 25100B | .0025/64 | .0100/254 | .0005/13 | .0004/10 | .0004/10 |
| 30030B | .0030/76 | .0030/76 | .0005/13 | .0004/10 | .0004/10 |
| 30040B | .0030/76 | .0040/102 | .0005/13 | .0004/10 | .0004/10 |
| 30060B | .0030/76 | .0060/152 | .0005/13 | .0004/10 | .0004/10 |
| 30080B | .0030/76 | .0080/203 | .0005/13 | .0004/10 | .0004/10 |
| 35060B | .0035/89 | .0060/152 | .0005/13 | .0004/10 | .0004/10 |
| 35100B | .0035/89 | .0100/254 | .0005/13 | .0004/10 | .0004/10 |
| 40060B | .0040/102 | .0060/152 | .0005/13 | .0004/10 | .0004/10 |
| 57067B | .0057/145 | .0067/170 | .0005/13 | .0004/10 | .0004/10 |
| 70070B | .0070/178 | .0070/178 | .0005/13 | .0004/10 | .0004/10 |
| 80080B | .0080/203 | .0080/203 | .0005/13 | .0004/10 | .0004/10 |
| 25120C | .0025/64 | .0120/305 | .0010/25 | .0008/20 | .0007/18 |
| 30120C | .0030/76 | .0120/305 | .0010/25 | .0008/20 | .0007/18 |
| 35060C | .0035/89 | .0060/152 | .0010/25 | .0008/20 | .0007/18 |
| 35070C | .0035/89 | .0070/178 | .0010/25 | .0008/20 | .0007/18 |
| 35080C | .0035/89 | .0080/203 | .0010/25 | .0008/20 | .0007/18 |
| 35100C | .0035/89 | .0100/254 | .0010/25 | .0008/20 | .0007/18 |
| 35120C | .0035/89 | .0120/305 | .0010/25 | .0008/20 | .0007/18 |
| 40040C | .0040/102 | .0040/102 | .0010/25 | .0008/20 | .0007/18 |
| 40050C | .0040/102 | .0050/127 | .0010/25 | .0008/20 | .0007/18 |
| 40060C | .0040/102 | .0060/152 | .0010/25 | .0008/20 | .0007/18 |
| 40080C | .0040/102 | .0080/203 | .0010/25 | .0008/20 | .0007/18 |
| 40100C | .0040/102 | .0100/254 | .0010/25 | .0008/20 | .0007/18 |
| 40120C | .0040/102 | .0120/305 | .0010/25 | .0008/20 | .0007/18 |
| 40210C | .0040/102 | .0210/533 | .0010/25 | .0008/20 | .0007/18 |
| 45075C | .0045/114 | .0075/191 | .0010/25 | .0008/20 | .0007/18 |
| 45100C | .0045/114 | .0100/254 | .0010/25 | .0008/20 | .0007/18 |
| 45120C | .0045/114 | .0120/305 | .0010/25 | .0008/20 | .0007/18 |
| 50025C | .0050/127 | .0025/64 | .0010/25 | .0008/20 | .0007/18 |
| 50050C | .0050/127 | .0050/127 | .0010/25 | .0008/20 | .0007/18 |
| 50120C | .0050/127 | .0120/305 | .0010/25 | .0008/20 | .0007/18 |
| 55060C | .0055/140 | .0060/152 | .0010/25 | .0008/20 | .0007/18 |
| 55080C | .0055/140 | .0080/203 | .0010/25 | .0008/20 | .0007/18 |
| 55120C | .0055/140 | .0120/305 | .0010/25 | .0008/20 | .0007/18 |
| 60220C | .0060/152 | .0220/559 | .0010/25 | .0008/20 | .0007/18 |
| 90060C | .0090/229 | .0060/152 | .0010/25 | .0008/20 | .0007/18 |

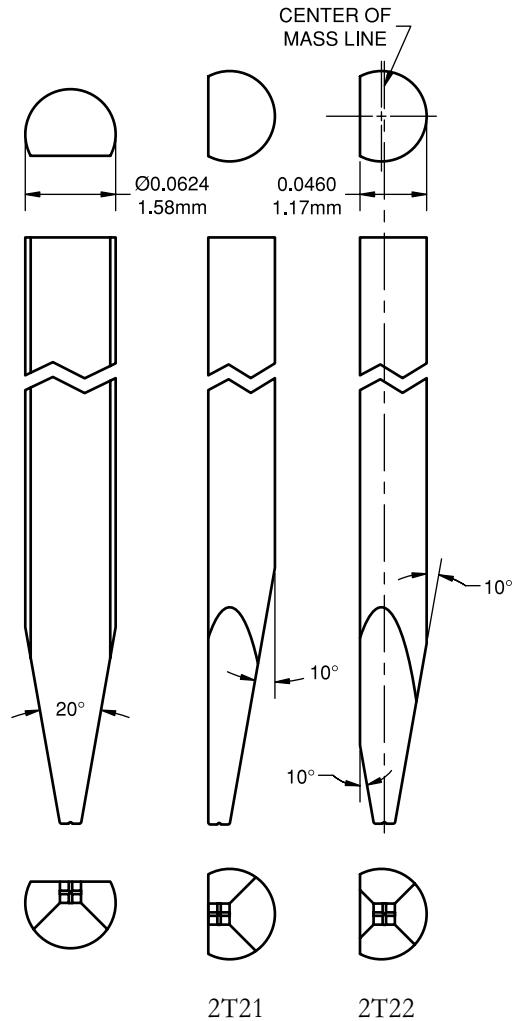
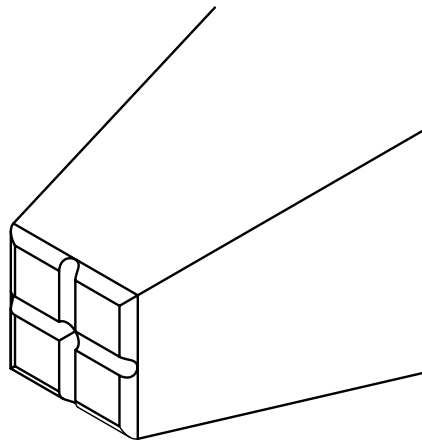
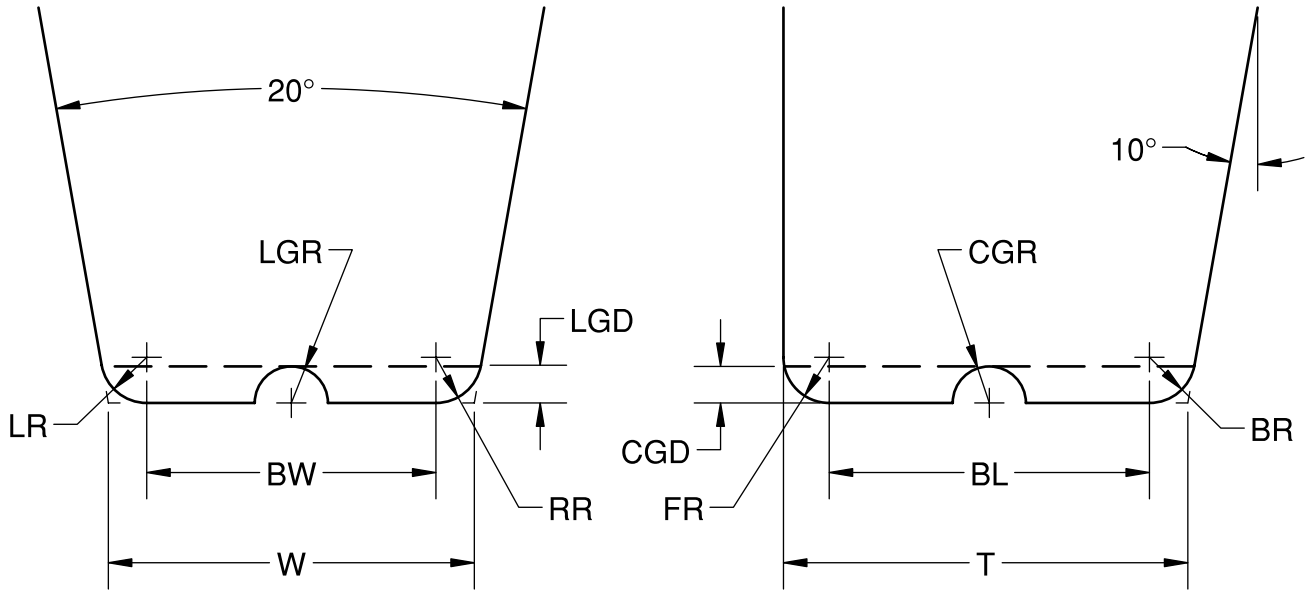

Material:

- Tungsten Carbide Standard
- TiC = Titanium Carbide
- BKCR = Cermet Tip
- DT = Diamond Tip

Options:

See Wedge Modifications

Lengths:

- 375 = 0.375 in./9.52mm
- S = 0.437 in./11.1mm
- 625 = 0.625 in./15.88mm
- 3/4 = 0.750 in./19.05mm
- L = 0.828 in./21.03mm
- 1.0 = 1.000 in./25.4mm
- Other = Specify

Specify: Series - Bond Length/BW/Radius & Groove Spec. - Shank Length - Options

Example:

2T21-35050C-S-TiC

2T22-45075C-3/4-20D

| DASH NUMBER | BL in./μm \pm.0002/5 | BW in./μm \pm.0002/5 | FR=BR=LR=RR in./μm \pm.0002/5 | W in./μm \pm.0002/5 | CGR=LGR in./μm \pm.0001/3 | CGD=LGD in./μm \pm.0001/3 |
|--------------------|---|---|--|--|--|--|
| 15015B | .0015/38 | .0015/38 | .0005/13 | .0023/58 | .0004/10 | .0004/10 |
| 20020B | .0020/51 | .0020/51 | .0005/13 | .0028/71 | .0004/10 | .0004/10 |
| 20032 | .0020/51 | .0032/81 | .0005/13 | .0040/102 | .0004/10 | .0004/10 |
| 20040B | .0020/51 | .0020/51 | .0005/13 | .0048/122 | .0004/10 | .0004/10 |
| 25025B | .0025/64 | .0025/64 | .0005/13 | .0033/84 | .0004/10 | .0004/10 |
| 25050B | .0025/64 | .0050/127 | .0005/13 | .0058/147 | .0004/10 | .0004/10 |
| 30030B | .0030/76 | .0030/76 | .0005/13 | .0038/97 | .0004/10 | .0004/10 |
| 30060B | .0030/76 | .0060/152 | .0005/13 | .0068/173 | .0004/10 | .0004/10 |
| 35040B | .0035/89 | .0040/102 | .0005/13 | .0048/122 | .0004/10 | .0004/10 |
| 40040B | .0040/102 | .0040/102 | .0005/13 | .0048/122 | .0004/10 | .0004/10 |
| 40060B | .0040/102 | .0060/152 | .0005/13 | .0068/173 | .0004/10 | .0004/10 |
| 45040B | .0045/114 | .0040/102 | .0005/13 | .0048/122 | .0004/10 | .0004/10 |
| 45045B | .0045/114 | .0045/114 | .0005/13 | .0053/135 | .0004/10 | .0004/10 |
| 50050 | .0050/127 | .0050/127 | .0005/13 | .0058/147 | .0004/10 | .0004/10 |
| 55040B | .0055/140 | .0040/102 | .0005/13 | .0048/122 | .0004/10 | .0004/10 |
| 30030C | .0030/76 | .0030/76 | .0010/25 | .0047/119 | .0008/20 | .0007/18 |
| 30050C | .0030/76 | .0050/127 | .0010/25 | .0067/170 | .0008/20 | .0007/18 |
| 30120C | .0030/76 | .0120/305 | .0010/25 | .0137/348 | .0008/20 | .0007/18 |
| 35050C | .0030/76 | .0050/127 | .0010/25 | .0067/170 | .0008/20 | .0007/18 |
| 40040C | .0040/102 | .0040/102 | .0010/25 | .0057/145 | .0008/20 | .0007/18 |
| 40060C | .0040/102 | .0060/152 | .0010/25 | .0077/196 | .0008/20 | .0007/18 |
| 40090C | .0040/102 | .0090/229 | .0010/25 | .0107/272 | .0008/20 | .0007/18 |
| 45045C | .0045/114 | .0045/114 | .0010/25 | .0062/158 | .0008/20 | .0007/18 |
| 50050C | .0050/127 | .0050/127 | .0010/25 | .0067/170 | .0008/20 | .0007/18 |
| 55070C | .0055/140 | .0070/178 | .0010/25 | .0087/221 | .0008/20 | .0007/18 |
| 55080 | .0055/140 | .0080/203 | .0010/25 | .0097/246 | .0008/20 | .0007/18 |
| 60060C | .0060/152 | .0060/152 | .0010/25 | .0077/196 | .0008/20 | .0007/18 |
| 60080C | .0060/152 | .0080/203 | .0010/25 | .0097/246 | .0008/20 | .0007/18 |
| 80080C | .0080/203 | .0080/203 | .0010/25 | .0097/246 | .0008/20 | .0007/18 |